

# GMPF RH RF

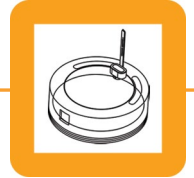

## Real Time Humidity Data Logger 0 to 100% RH non condensing



- + Collects and transmits real time humidity and temperature to XpertLog Software
- + ITS-90 calibration coefficients are stored in the internal memory
- + Complies with FDA 21 CFR Part 11
- + Network ready: multiple users, centralized, server database, active directory authentication
- + Can be remotely activated

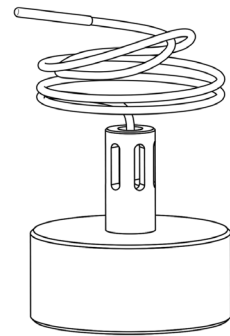
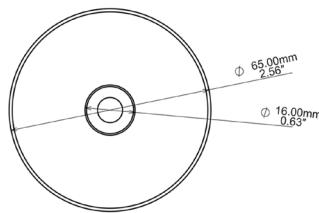
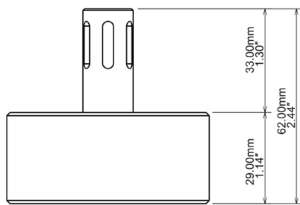

Sensor type	RH: capacitive / Temp: 4 wires PT-100
- flexible	480 mm (19")
- customized	up to 5000 mm (195")
- sensor size	1.5 x 8 mm (0.06 x 0.315")
- cross section	1.77 mm <sup>2</sup> (0.0027 inch <sup>2</sup> )
Operating Range	0 to 100% RH non condensing
- body	-40°C to +100°C
- sensor	-200°C to +200°C
Accuracy	±2.0% RH, 0% to 100% non condensing at 20°C to 45°C
	±0.1°C from -40 to +100°C
Resolution	0.01% RH; 0.01°C
Memory capacity	16,000 data points humidity / 16,000 data points temperature
Memory type	non volatile
Sampling rate	1 sec to 24 hours
Transmission	simultaneous: maximum 20 loggers
	sequential: unlimited
Internal clock drift	4 sec / 24 h @ 23°C
Mechanical	
- material	Peek 1000 - FDA compliant
- enclosure	IP-51
- weight	95 g (3.35 oz)
- diameter	65 mm (2.56")
- height	62 mm (2.44")
Power	2 x Lithium batteries, 0.35 g/each Lithium content classified UN3091 under IATA DGR section 3.9.2.6 compliant with ICAO/IATA packing instructions 970, user replaceable
Battery lifetime	Up to 6 months, based on usage
Antenna	Internal
Wireless range	121 m (400 feet)
Radio frequency	2.4 Ghz ISM band
Access point	USB to computer
Calibrations	Programs and reads unlimited number of loggers
	Factory Calibrations: traceable NIST/COFRAC - ITS-90 coefficients stored in the internal memory
	User Calibrations: close loop calibration using XpertLog® software
Certification	Health Safety: EN 60950-1 / 2006
	EMC: EN 60601-1-2 / 2007
	RF: EN 300440-2 v1.3.1 (2009-03)

Order Reference  
GMPF-RH\_RF

### Standard Calibration Points

- 25° C/20%RH
- 25° C/45%RH
- 30° C/65%RH
- 40° C/75%RH

Upon special request:

- 45° C/90%RH

